

MEMORANDUM

TO: Gregg Mandsager, City Administrator
FROM: Richard Klimes, Director of Parks and Recreation
DATE: August 1, 2011
RE: Request to Accept Donation of Property to City



INTRODUCTION:

Please accept this memo and the attached information as a request for the City Council to accept the proposed donation of property to the City.

BACKGROUND:

As the attached letter from Mrs. Linda Hinman explains, she would like to donate Lots 4 and 5, Block 5 of South Park Addition and Lots 14 and 15, Block 4 of South Park Addition to the City of Muscatine for the benefit of the Youth of Muscatine. Additionally, she would like the City to incur all transfer of property costs and if the property within the next 20 years is used for anything other than for the Youth of Muscatine it be converted back to the Linda C. Hinman Trust. Mrs. Hinman is not requiring a time line for development and she does understand that she is responsible for all back taxes if any exist.

The proposed property is adjacent to City owned property that has been approved in the City's recent Capital Improvement Plan. The donation of this land will enhance the Kent Stein Park Multi-Use Area Project as the additional space will allow for regulation size playing surfaces to be established.

RECOMMENDATION:

At this time, the City staff would recommend that the City Council accept the proposed donation of Lots 4 and 5, Block 5 of South Park Addition and Lots 14 and 15, Block 4 of South Park Addition from the Linda C. Hinman Trust with the understanding that Mrs. Hinman will be responsible for all back taxes if any exist, and she will provide the current Abstract. The City will be responsible for filing fees, transfer fees and attorney fees.

The Muscatine Advisory Commission did fully endorse the acceptance of the before mentioned proposed donation of land at their June 2011 Regular Meeting.

BACKUP INFORMATION:

1. Letter from Mrs. Linda Hinman

Thank you for your time and attention to this matter. Please contact me if you have any comments, questions or concerns.

C: Nick Gow, Athletic Facilities Manager
Steve Boka, Director of Community Development

June 15, 2011

Muscatine City Hall
Attn: Rich Klimes
215 Sycamore Street
Muscatine, Iowa 52761

Dear Rich;

On behalf of the Linda C Hinman Trust U/A DTD 10/05/00, I would be willing to donate the following parcels-Lots 4 & 5 Block 5 of South Park Addition and Lots 14 & 15 Block 4 of South Park Addition to the City of Muscatine with the following stipulations.

1. This property would be donated for the benefit of the Youth of Muscatine .
2. All cost incurred in the transfer of this property would be paid by the City of Muscatine. (i.e. Filing fees, Transfer fees, Property taxes, Attorney fees, etc.)
3. If this property were converted in to some other type of space (i.e. Parking Lots, Bike/Walking Paths, Dog Park, etc.) within 20 years from the date of this transfer ownership would revert back to the Linda C Hinman Trust.

Value of this property to be determined at time of donation.

You may contact me at 563-299-5143

Sincerely,

A handwritten signature in cursive script, appearing to read "Linda Hinman".

Linda Hinman
2474 Prairie Rose Ridge
Muscatine, Iowa 52761

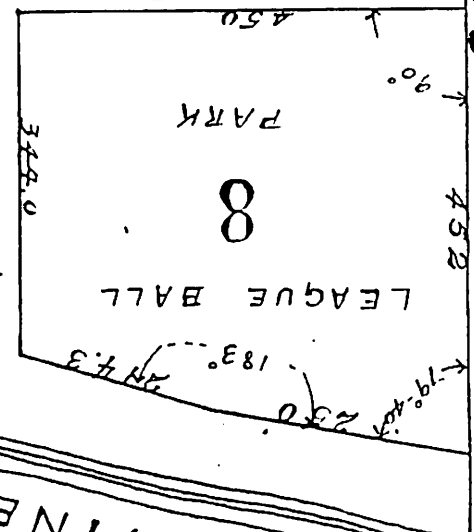

ST. ST.

1	2	3	4	5	6	7	8	9	10	11	12	13	14	15	16	17	18	19	20	21	22	23	24	25	26	27	28	29	30
1	2	3	4	5	6	7	8	9	10	11	12	13	14	15	16	17	18	19	20	21	22	23	24	25	26	27	28	29	30

MILWAUKEE

1	2	3	4	5	6	7	8	9	10	11	12	13	14	15	16	17	18	19	20	21	22	23	24	25	26	27	28	29	30
1	2	3	4	5	6	7	8	9	10	11	12	13	14	15	16	17	18	19	20	21	22	23	24	25	26	27	28	29	30

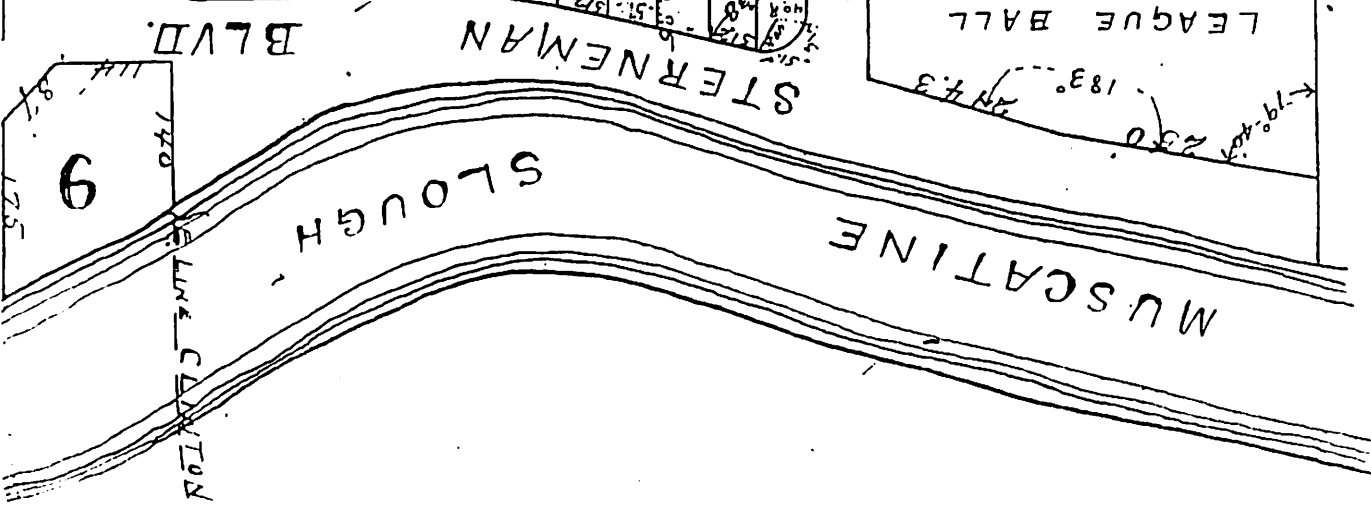

MONUMENT

1	2	3	4	5	6	7	8	9	10	11	12	13	14	15	16	17	18	19	20	21	22	23	24	25	26	27	28	29	30
1	2	3	4	5	6	7	8	9	10	11	12	13	14	15	16	17	18	19	20	21	22	23	24	25	26	27	28	29	30

ST. ST.

1	2	3	4	5	6	7	8	9	10	11	12	13	14	15	16	17	18	19	20	21	22	23	24	25	26	27	28	29	30
1	2	3	4	5	6	7	8	9	10	11	12	13	14	15	16	17	18	19	20	21	22	23	24	25	26	27	28	29	30

MONUMENT

1	2	3	4	5	6	7	8	9	10	11	12	13	14	15	16	17	18	19	20	21	22	23	24	25	26	27	28	29	30
1	2	3	4	5	6	7	8	9	10	11	12	13	14	15	16	17	18	19	20	21	22	23	24	25	26	27	28	29	30